

HYDRAULIC CLAMPS

HYDRAULIC GRIPS • HYDRAULIC GRIPPERS
HYDRAULIC GRIPPERS



GHEDINI
ATTACHMENTS

Serie QP

QP Series • QP Series • SeriesQP

FOR EXCAVATORS FROM 2.5 TO 25 TON - FOR EXCAVATORS FROM 2,5 250 TON
FOR EXCAVATORS FROM 2.5 TO 25 TON - FOR BAGGER FROM 2,5 25NTIL TON

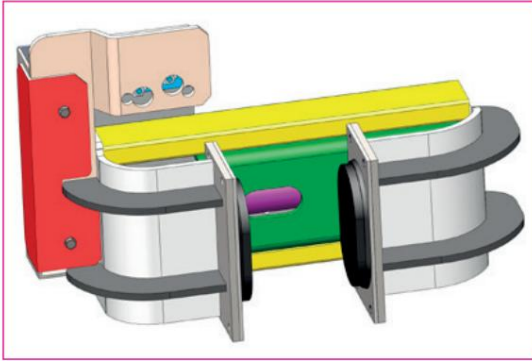

QP 27

Pliers with fixed pads for extraction/driving for gripping concrete/iron poles. Interchangeable pads for special uses (plant extraction, vineyards, etc.)

Grip with fixed buffers for the extraction and the driving of concrete/iron posts. Interchangeable buffers for special needs (extraction of plants, vineyards and so on.)

Clamp with fixed silemblocs for extracting and driving concrete and iron piles. Interchangeable silemblocs for special works (extraction of plants, vineyards etc.)

Grapples with fixed buffers for the extraction and driving of concrete and iron piles. Interchangeable buffers for special work (extraction of plants, vineyards, etc.)

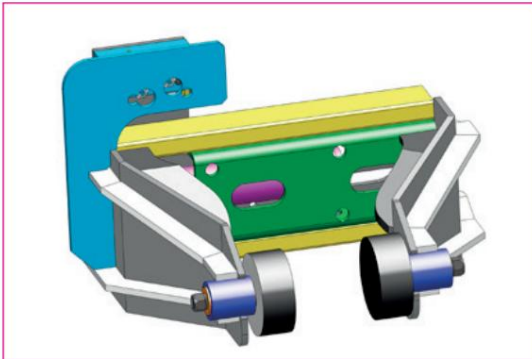

QP 28

Revolving pad gripper with bearing guide for gripping concrete/iron poles.

Grips with rotating buffers and sliding bearings for concrete/iron posts.

Clamp with pivoting silemblocs and bearing guide for concrete and iron piles.

Gripper with rotary buffers and bearing guide for concrete and iron piles.



QP 36

Pliers for gripping wooden poles. For IP 2x and 3x series.

Grips for wood posts. For IP 2x and 3x series.

Clamp for wooden piles. For IP 2x and 3x series.

Gripper for wooden posts. For series IP 2x and 3x.

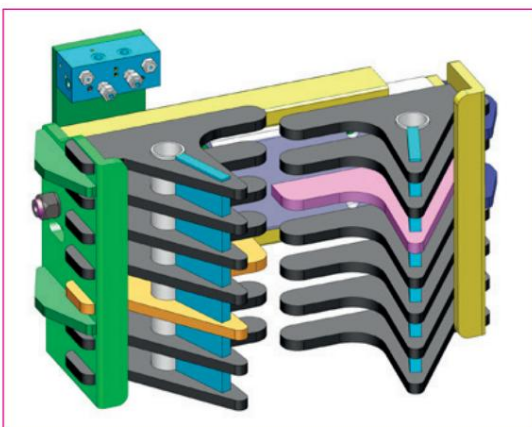

QP 39

Pliers for gripping wooden poles. Reinforced model 20 mm thick. For IP 5x series.

Grips for wood posts. Reinforced model with thickness 20 mm. For IP 5x series.

Clamp for wooden piles. Reinforced model with thickness 20 mm. For IP 5x series.

Gripper for wooden posts. Reinforced model with a thickness of 20 mm. For IP 5x series.



QP 27

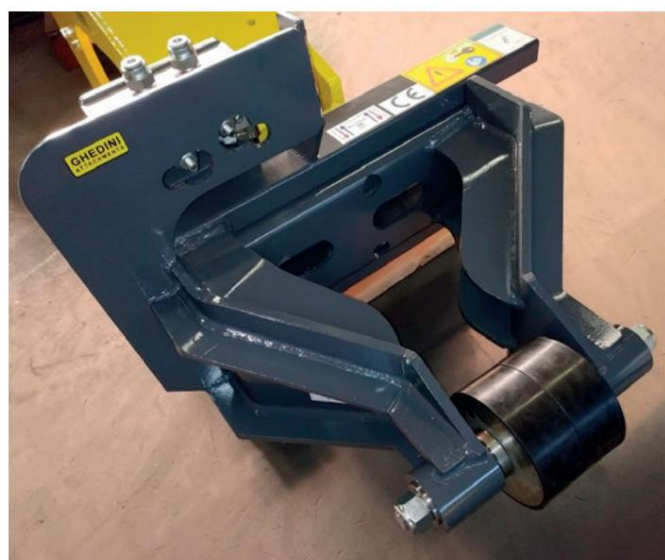

QP 28



QP 36



QP 39

TECHNICAL CHARACTERISTICS •

TECHNICAL DETAILS • TECHNICAL DATA •

TECHNICAL CHARACTERISTICS

Model - Model - Model - Model		QP 27	QP 28	QP 36	QP 39
Max Oil Flow - Max Oil flow Max flow - Max Öldurchfluss	l/min	40			
Max Pressione - Max Pressure - Pressure maxi - Max pressure	bar	60		80	
Apertura min-max - Min-max opening Min-max ouverture - Min-max opening	mm	20-320		60-360	
Peso - Weight - Poids - Gewicht	Kg	100	110	150	250
Standard valve Standard valves Series valves Stock valves		Pressure regulating valve and slam-shut valve Pressure regulating valve and lock valve Pressure regulating and shut-off valve Pressure control valve and shut-off valve			
Excavator weight - Excavator weight Excavator weight - Gewicht des Baggers	ton	2,5 - 10		3,5 - 11	12 - 25