



17th November 2022

Dear Parents and Carers,

Spensley Street Primary School is looking forward to another great year of teaching and learning and we would like to advise you of our School Council approved parent contribution arrangements for 2023.

Background:

Victorian schools provide students with free instruction to fulfil the standard Victorian curriculum and we want to assure you that all parent contributions are voluntary. Nevertheless, the ongoing support of our families ensures that our school can continue to offer the best possible education, facilities and support for our students. We want to thank you for all your support, whether that's through fundraising or volunteering your time. This continues to make a huge difference to our school and the programs we can offer.

A free public education in Victoria means that Victorian government schools must teach the standard curriculum to all students for free. This covers Prep to year 12. Each school receives funding from the government to teach the standard curriculum. This funding pays for

- staff to do the teaching and run the school;
- the basic building and current facilities; and
- extra support for children with a disability.

All schools in Victoria are funded by the Department of Education and Training (DET) based on the number of students who attend the school, and according to socioeconomic criteria (the Index of Community Socio-Educational Advantage-ICSEA).

As Spensley Street ranks very high on the ICSEA Index, this directly affects our school funding as the higher the ranking, the less government funding we receive.

Parent Contribution Arrangements for 2023:

In order for Spensley Street to provide students with a wider variety of programs and resources along with ensuring that our school facilities are up to date and well maintained, locally raised funds are critical to our school. The voluntary parent contributions are a very important way that we raise those funds.

A detailed schedule of parent contributions is presented over page. There has been no increase to the total amounts in each section. The contributions are classified as Curriculum, Other and Building Fund. Contributions to the Building Fund are tax-deductible.

Payment Method

The Compass Course Confirmation / School Payments module allows you to pay online by card. Payment may be made in full or by establishing a payment plan. You can select this as an option in the payment section. This will be open for payment in January 2023.

Financial Support for Families

Spensley Street prides itself on being an inclusive community where all children are provided with the best education regardless of their financial circumstances. If your family is experiencing financial hardship or holds a means-tested Centrelink card please speak with the Principal about payment options in early 2023.

For further information on the Department's Parent Payment Policy please see a one-page overview attached.

Thank you for your continued support of our school.

Yours sincerely,

Bec Spink
Principal

Katie Brown
School Council President



Fee schedule – Prep-Year 6

Please find the itemised list of parent contributions and optional items for your child.

Curriculum Contributions - items and activities that students use, or participate in, to access the Curriculum	Amount
Student Stationery Items	\$70
Cultural Arts Program	\$60
Online Learning Subscriptions (Mathletics, Online ACER Tests, mClass (DIBELS) & Essential Assessment)	\$58
Provision & Upkeep of School Technology Equipment	\$20
Consumable materials which students use across all learning areas	\$200
TOTAL	\$408

Other Contributions	Amount
The additional costs below are for items & activities that are not provided by the Department of Education used to enhance and broaden the schooling experience of students.	
Materials, equipment, training and staff development for all school programs, English, Mathematics, Changes, Music, Art, Italian, Library, STEAM, JSC, Green Team, and Wellbeing.	\$165
Edible Garden	\$55
<i>In addition to our education programs this voluntary parent contribution also supports:</i>	
First Aid Supplies	\$10
Ongoing Grounds Maintenance	\$90
TOTAL	\$320

Building Fund Voluntary Contribution- Tax Deductible	Amount
Upgrading Area Wet Spaces (see below for draft plans) We are still saving the majority of our building fund donations so we can upgrade the sink and wet spaces in each of the areas. Currently, none of these are functional. This will give our students more useful workspaces within the Areas for practical, 'messy' and creative learning tasks. In 2022 we have saved \$50 000 to go towards this project and we hope to do the same in 2023. We will begin the quote process early next year. (See draft plans over page).	
Donations from our Building fund also go towards general and emergency maintenance of school buildings including repairs, painting and plumbing etc.	
TOTAL <i>Suggested amount</i>	\$300-\$900+ <i>per family</i>

Optional Items
<p>2023 Spensley Street PS additions to the standard school-based curriculum:</p> <ul style="list-style-type: none"> ● Excursions & Incursions ● Glen Forbes Camps ● Year 6 Camp ● Interschool Sport ● P-3 Gymnastics ● Events- Eg Year 6 Dinner ● School Photos <p><i>Payment for these items will be collected as they occur throughout the year via Compass.</i></p>



What will your Building Fund donation go towards?
Draft plans for upgrading our learning areas:

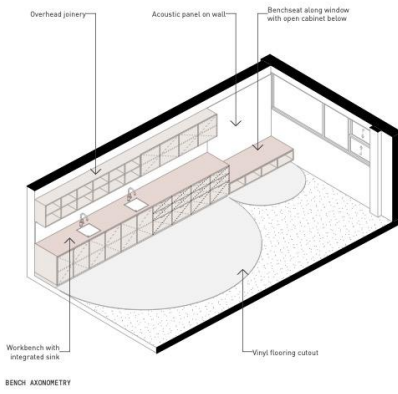
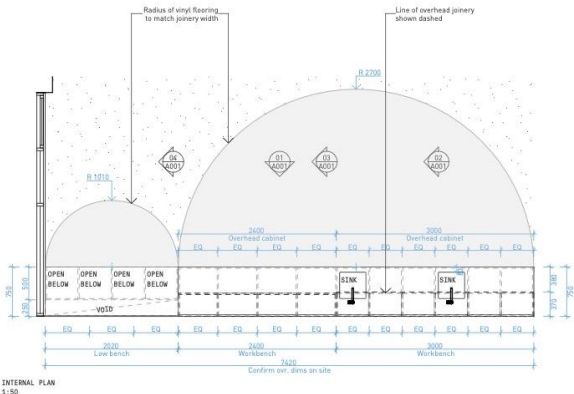
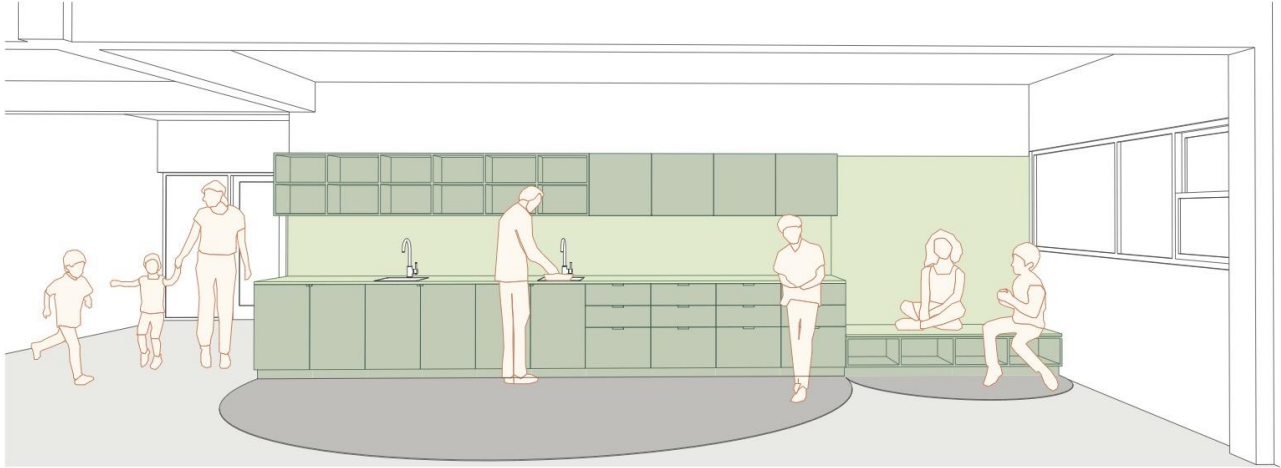

KEY TO SYMBOLS/ABBREVIATIONS

- Double GPO
- Waterproof Double GPO
- Telephone/Data Point
- TV Point
- Tile Setout Direction
- EQ Equal Length
- AD Adjustable
- F Fixed
- D Drawer
- R Hanging Rail
- O Open

LX1	LAMINEK LAMINATE	COLOUR TBC
BT1/BS1	LAMINEK LAMINATE	COLOUR TBC
VN1	FORNO SPHERE ERGONETIC	COLOUR TBC
AT1	AUTEX CUBE 100W	COLOUR TBC
SINK	CAROMA COMPASS SINGLE BOWL OVERMOUNT	STAINLESS STEEL
MIXER	CAROMA POSITION SINK MIXER	CHROME
LTP PULL	BARREN BAC-LP6	25mm/100mm

PROVIDE CONCEAL GPO ACCESS TO ALL INTEGRATED APPLIANCES.
 CONCEAL TRAP OF INTEGRATED SINK IN CABINET & ALLOW PLUMBING CONNECTION THROUGH FLOOR/WALL.
 WHITE CARCASSES & ADJUSTABLE SHELF TO ALL JOINERY WITH DOOR UNLESS STATED OTHERWISE.
 ALL CABINET DOORS/DRAWERS TO HAVE SOFT-CLOSE MECHANISM.

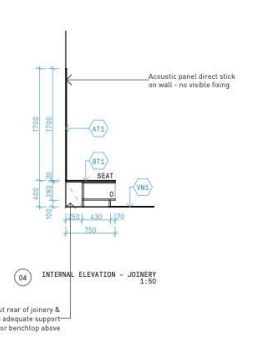
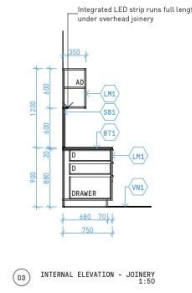
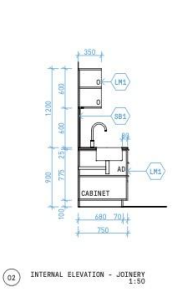
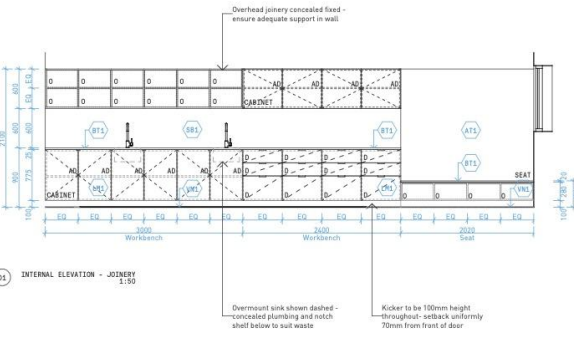

Drawings are to be read in conjunction with specification, schedules and contractor's drawings. Verify all dimensions at the job before commencing any work or preparing any shop drawings. Do not scale drawings. Use dimensioned values only. Report any discrepancies and seek instructions prior to commencing any work, including materials or preparing shop drawings. It is the contractor's responsibility to ensure that the works are being constructed using the correct interpretation of all drawings. All reproduced versions of drawings, including those issued for third parties, should be destroyed. All works to be carried out in compliance with Australian Standards and the ACTRA.

PROJECT NAME: **BENCH JOINERY**

DATE: 04/11/22

SCALE: 1:50

PROJECT NO: SPENSLY ST PRIMARY SCHOOL

REV: A3

REV: BV EL

A001

NOT FOR CONSTRUCTION



PARENT PAYMENTS POLICY

ONE PAGE OVERVIEW



FREE INSTRUCTION

- Schools provide students with free instruction and ensure students have free access to all items, activities and services that are used by the school to fulfil the standard curriculum requirements in Victorian Curriculum F-10, VCE and VCAL.
- Schools may invite parents to make a financial contribution to support the school.



PARENT PAYMENT REQUESTS

Schools can request contributions from parents under three categories:

Curriculum Contributions

Voluntary financial contributions for curriculum items and activities which the school deems necessary for students to learn the Curriculum.

Other Contributions

Voluntary financial contributions for non-curriculum items and activities that relate to the school's functions and objectives.

Extra-Curricular Items and Activities

Items and activities that enhance or broaden the schooling experience of students and are above and beyond what the school provides for free to deliver the Curriculum. These are provided on a user-pays basis.

- Schools may also invite parents to supply or purchase educational items to use and own (e.g. textbooks, stationery, digital devices).



FINANCIAL HELP FOR FAMILIES

- Schools put in place financial hardship arrangements to support families who cannot pay for items or activities so that their child doesn't miss out.
- Schools have a nominated parent payment contact person(s) that parents can have a confidential discussion with regarding financial hardship arrangements.



SCHOOL PROCESSES

- Schools must obtain school council approval for their parent payment arrangements and publish all requests and communications for each year level on their school website for transparency.