



@nor_livingspace
OPENING
NOVEMBER 2019



Situated on the corner of Archfisher Drive and Angelfish drive. The centre is an exciting retail development that will cater for the residential community of Tembisa, with only their most needed shops due to the size of the centre. The location is amazing and on eye level with an Engen Service Station.



ADDRESS:

CORNER OF ARCHFISHER DRIVE AND
ANGELFISH DRIVE. TEMBISA,
JOHANNESBURG

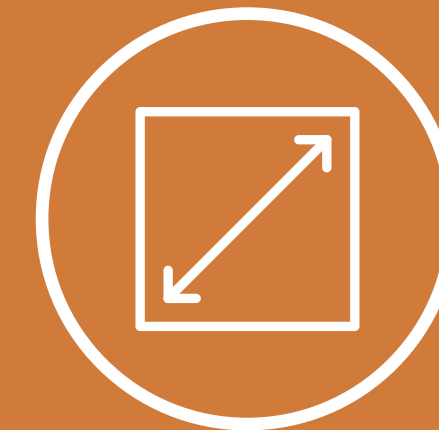

GLA:

±1 447m²



COMPLETION DATE:

1 APRIL 2017

CENTRE PICTURES





SITE LAYOUT PLAN RETAIL LEVEL

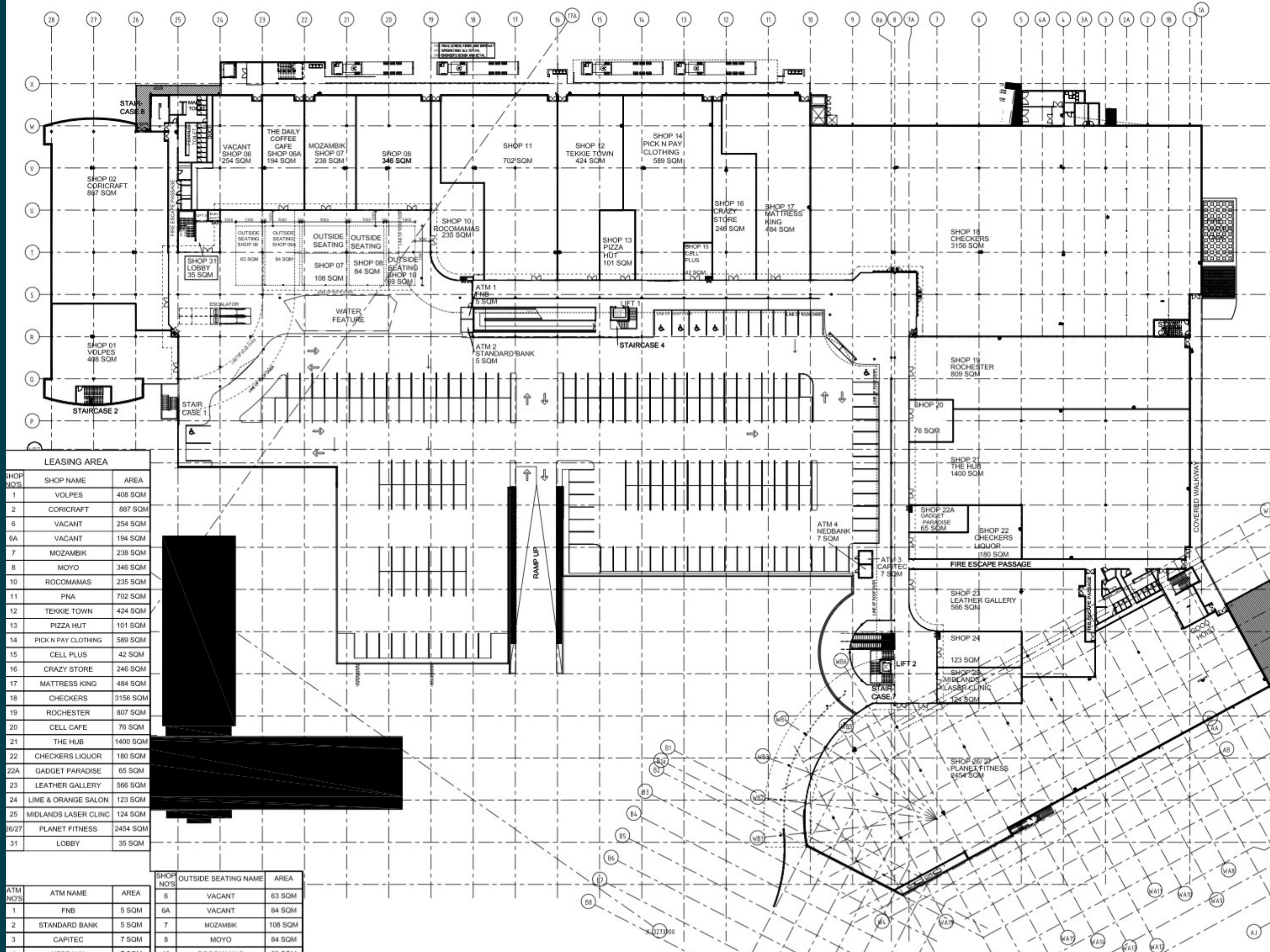

SITE LAYOUT PLAN BASEMENT LEVEL

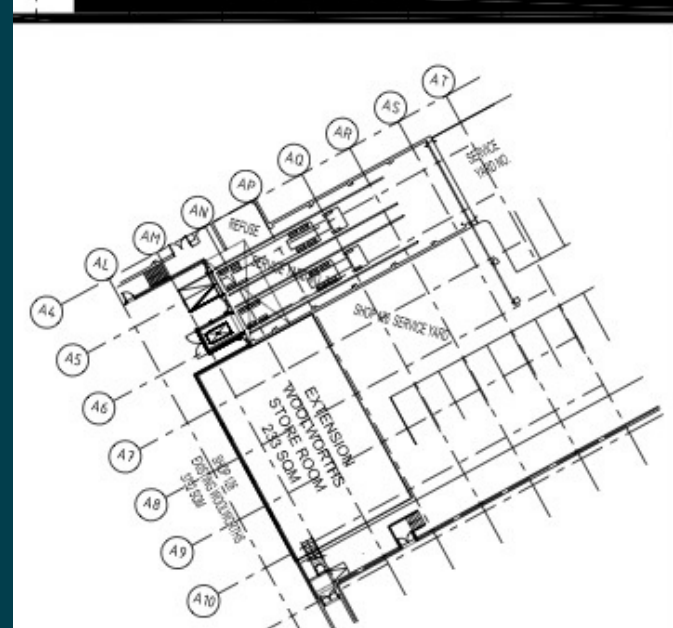
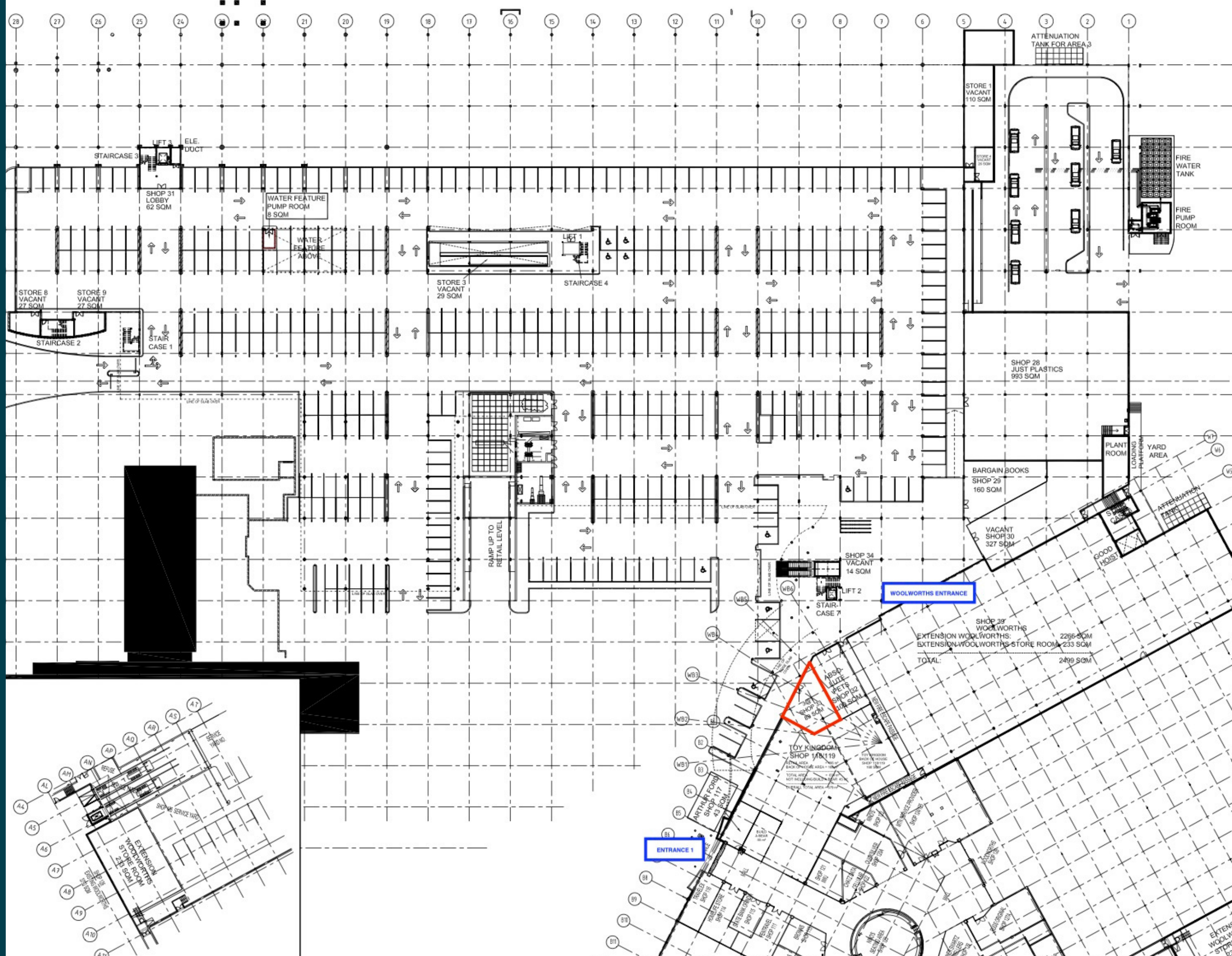

ENTRANCE 1

WOOLWORTHS ENTRANCE

| | |
|---------------------------------|----------|
| SHOP 39 WOOLWORTHS | 2296 SQM |
| EXTENSION WOOLWORTHS STORE ROOM | 233 SQM |
| TOTAL: | 2499 SQM |



LEASING ENQUIRIES



ANCORA GROUP

info@ancoragroup.co.za

087 057 0487

ANCORA
RETAIL PROPERTY SPECIALISTS